

PET PRODUCTS PARTS LIST



ENGINEERING - MANUFACTURING - QUALITY

BLOWER S2 & S2+ MACHINES

Toll free : 1-866-454-2493

Fax : (450) 454-2477

Web Site : www.um-inc.com

VERSION: 20150901



ENGINEERING CAPABILITIES



3D printing

With or without a CAD file, UM can design and print your ideas. We give you the opportunity to have a prototype to test before spending money on parts improperly designed.

CMM measurement

Get very precise measurements of any parts with our CMM equipment; nothing compares to its precision.



3D scan

With its portable equipment, UM can come on site and scan any complex equipment and parts.

S2 & S2+ MACHINES

UM ALTERNATE SPARE PARTS CATALOG



MACHINE SECTIONS

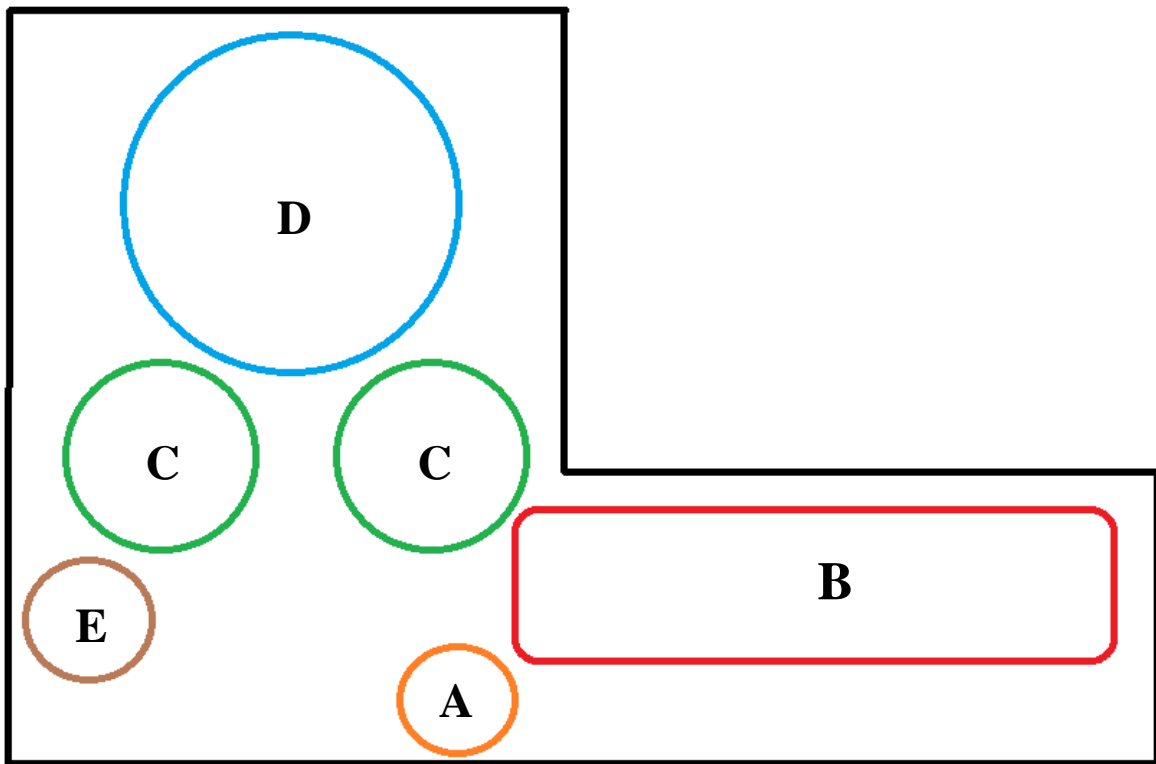

SECTION A : ENTRY WHEEL/PREFORM CHANGE	7
SECTION B : OVEN	8
SPINDLE TIPS	8
EJECTOR	8
INDIVIDUAL OVEN CHAIN PARTS	9
OVEN WHEEL EJECTOR SHAFT	12
SECTION C : TRANSFER WHEEL	13
GRIPPERS	13
IMPROVED QUICK CHANGE TRANSFER ARM HEAD	14

SECTION D : BLOWING WHEEL	15
GUPM	16
WATER JACKETS	21
STRETCH ROD CLAMP ASSEMBLY	22
STRETCH ROD CYLINDER	23
BLOW NOZZLE COMPONENTS (INCLUDING PDP PARTS)	24
ROTARY UNION	28
HIGH PRESSURE VALVES (S2 & S2+)	29
LOCK & UNLOCK CAM	35
 SECTION E : EXIT WHEEL	 36
EXIT GUIDE	
 UM GENERAL INFORMATION	 37

A : ENTRY WHEEL



PREFORM CHANGE/TOOL CHANGE

UM'S ENGINEERING TEAM CAN HELP YOU DESIGN ALL THE CUSTOM PARTS REQUIRED TO CHANGE FROM ONE PREFORM TO ANOTHER.

WITH ITS EQUIPMENT AND KNOW HOW, UM'S ENGINEERING TEAM WILL KEEP ALL THE REQUIRED OEM SPECIFICATIONS.

Infeed Unit



Infeed Plate



Improved Spindle Tips



Retractable Guide



Complete Under Neck and Upper Guides



B : OVEN CHAIN

CHAIN LINK CHAIN COMPONENTS (QUICK CHANGE)

INDIVIDUAL COMPONENTS CAN BE PURCHASED, SEE PAGE 9



IMPROVED SPINDLE TIP

UM CAN DESIGN A GRIPPER TO PERFECTLY FIT ANY PREFORM.
SIMPLY PROVIDE A PREFORM DRAWING AND/OR SAMPLES.
2 WEEKS LEAD TIME FOR CUSTOM DESIGN



PCO 1881 SPINDLE TIPS

0002-018-01-23

STOCK ITEM

EJECTOR

UM CAN DESIGN A EJECTOR TO PERFECTLY FIT ANY PREFORM.
SIMPLY PROVIDE A PREFORM DRAWING AND/OR SAMPLES.
2 WEEKS LEAD TIME FOR CUSTOM DESIGN



PCO 1881 EJECTOR

UMS-01135622901

STOCK ITEM

LINEAR OVEN SPINDLE ASS'Y

QUICK CHANGE

ASSEMBLY DRAWING

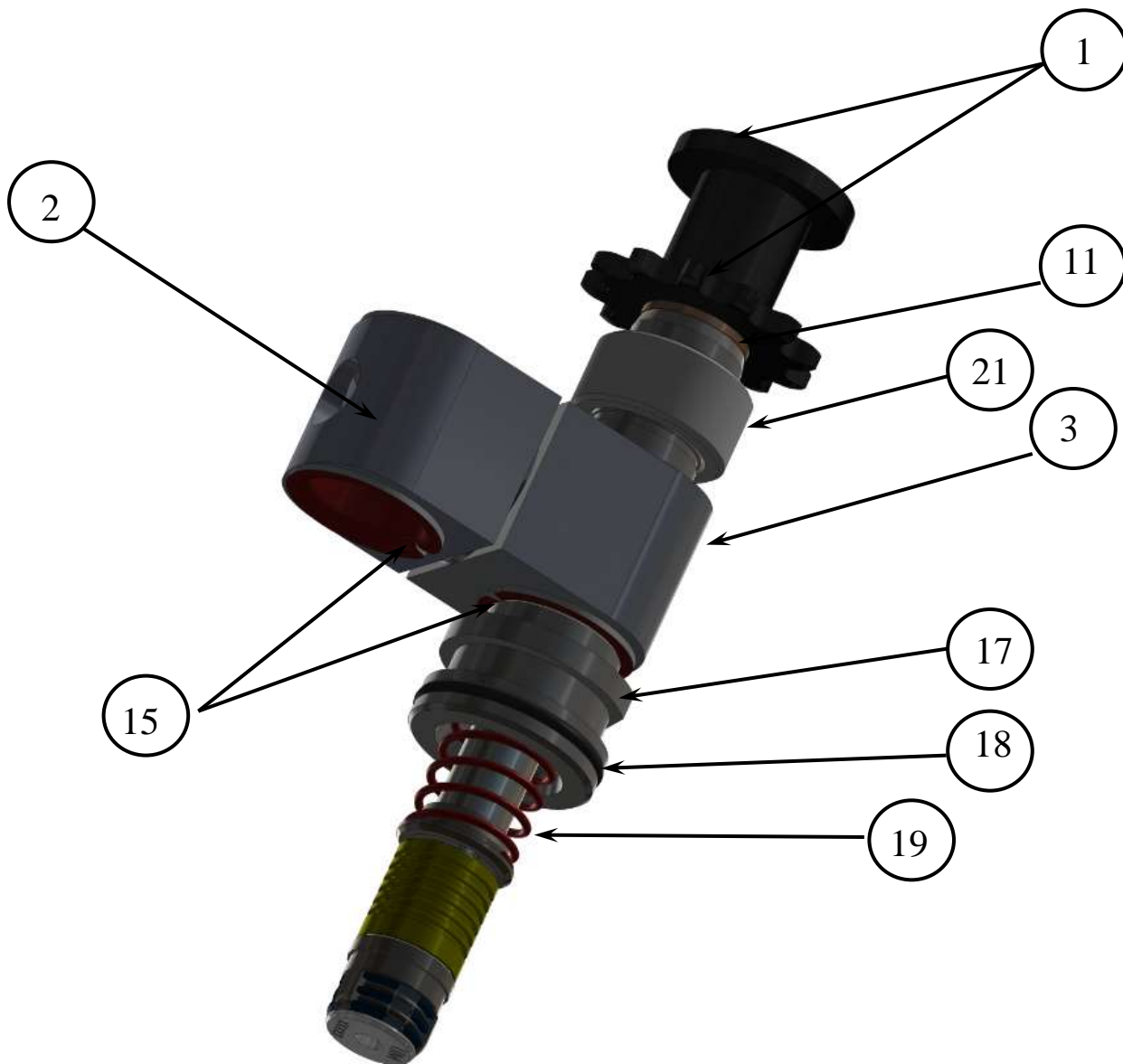

LINEAR OVEN SPINDLE ASS'Y QUICK CHANGE

ASSEMBLY DRAWING

MAIN AXLE (TOP SPROCKET)

UMS-011424556

INCLUDES # **1** ON LINEAR OVEN SPINDLE ASSY DRAWING



CONVEX LINK

UMS-01072508403

INCLUDES # **2** ON LINEAR OVEN SPINDLE ASSY DRAWING



CONCAVE LINK

UMS-01072508302

INCLUDES # **3** ON LINEAR OVEN SPINDLE ASSY DRAWING



BAYONET RING

UMS-01071607902



SELF-LUBRICATING BEARING

UMS-1153

INCLUDES # **11** ON LINEAR OVEN SPINDLE ASSY DRAWING



BEARING

UMS-1600

INCLUDES # **15** ON LINEAR OVEN SPINDLE ASSY DRAWING



EXTERNAL RETAINING RING

UMS-15120 & UMS-15113



SUPPORT

INCLUDES # **17** ON CHAIN LINK ASSY DRAWING



O-RING

UMS-20846

INCLUDES # **18** ON LINEAR OVEN SPINDLE ASSY DRAWING



BEARING RING

UMS-01124185601

INCLUDES # **21** ON LINEAR OVEN SPINDLE ASSY DRAWING



“H” LINK

UMS- 01069841102



SPRING

UMS- 01067139801

INCLUDES # **19** ON LINEAR OVEN SPINDLE ASSY DRAWING



OVEN WHEEL EJECTOR SHAFT



EJECTOR PIN

OEM: 01072505402

UMS-725054



SPRING

OEM: 01065289200

UMS- 01065289200

SELF LUBRICATING BUSHING

OEM: 000000001138

UMS-000000001138

FORK

OEM: 010772501103

UMS- 010772501103

WHEEL

OEM: 000000000349

UMS- 000000000349

NUT

OEM: 000000013386

UMS- 000000013386

C : TRANSFER WHEEL

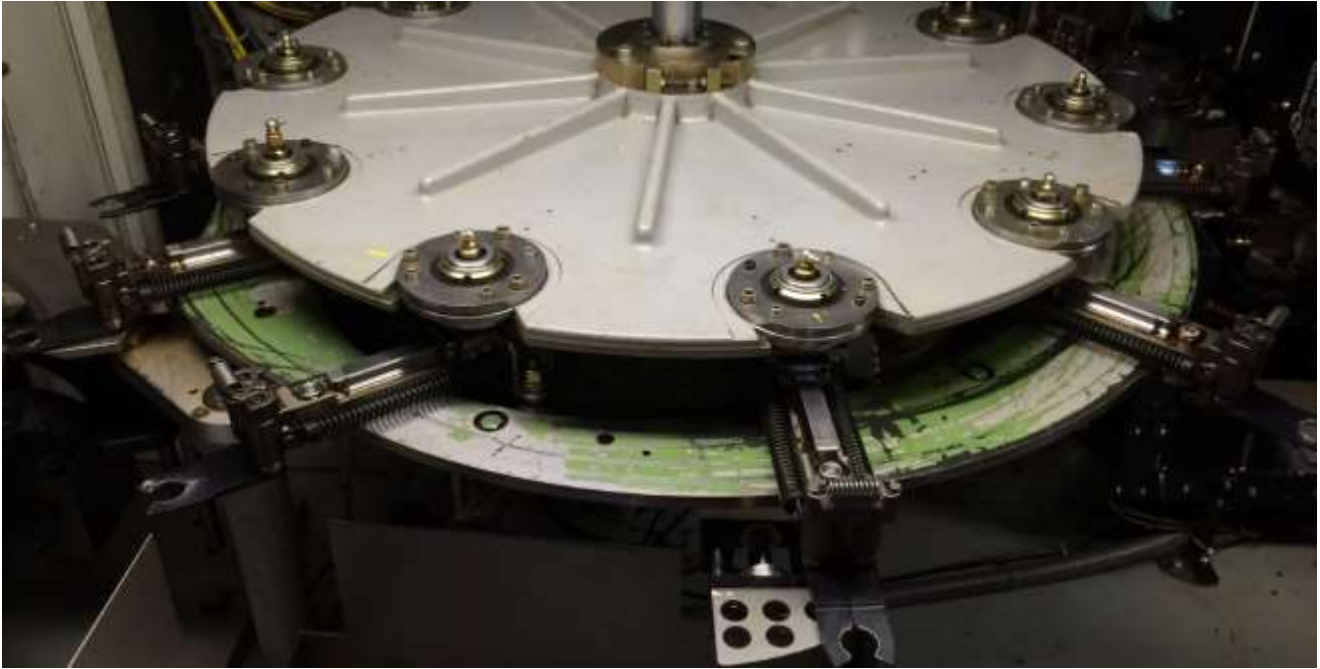

TRANSFER GRIPPERS **PERSONALIZED COMPONENTS**

UM CAN DESIGN A PAIR OF TRANSFER GRIPPERS TO PERFECTLY FIT ANY PREFORMS



SIMPLY PROVIDE A PREFORM DRAWING AND/OR SAMPLE.

INFEED GRIPPERS PCO 1881
0002-502-10-01

OUTFEED GRIPPERS PCO 1881
0002-502-20-01

IMPROVED QUICK CHANGE ARM HEAD

IMPROVED ARM HEAD

0002-502-30-00



D : BLOWING WHEEL



GUPM



IMPROVED PNEUMATIC SUPPORT PLATE

OEM: 01124526305

UMS-245263



IMPROVED BUFFER BOX

UMS-745938

OEM # : 01074593801



IMPROVED COMPENSATION BUMPER (HEAT SET)

0002-079-05-13

OEM # : Replace the spring # 00000002248



IMPROVED COMPENSATION BOLT SHORT
0002-079-01-46



IMPROVED COMPENSATION BOLT LONG
0002-079-01-45



IMPROVED COMPENSATION BOLT
UMS-734326



LOCKING PIN
OEM: 01117231501
UMS-172315



DOUBLE ROLLER PIN
OEM: 01120392501
UMS-203925



NUT
OEM: 13322
UMS-13322



THRUST, LOWER CONSOLE
OEM: 01127554702
UMS-275547



REAR SLIDE
OEM: 01069215402
UMS-692154



LOCK THRUST
OEM: 01069215803
UMS-692158



DOUBLE SPLIT RING

OEM: 01069216100

UMS-692161



INTERNAL RING

OEM: 01069649403

UMS-696494



EXTERNAL RING

OEM: 01069649502

UMS-696495



WASHER

OEM: 1069649601

UMS-696496



PIN

OEM: 01069647503

UMS-696575



GUIDING RING

OEM: 01071518901

UMS-715189



COMPENSATION SCREW

OEM: 01071552202

UMS-715522



MOLD LOCKING STROKE PIN

OEM: 01071552801

UMS-715528



MOLD LOCKING PIN

OEM: 01072320703

UMS-723207



GUIDE PIN

OEM: 01072501201

UMS-725012



LOWER SPRING GUIDE

OEM: 01072804602

UMS-728046



INNER RING

OEM: 01073046602

UMS-730466



LOCKING FINGER

OEM: 0107333530

UMS-733353



PIN

OEM: 01074703403

UMS-747034



SHACKLE

OEM: 011291123101

UMS-2911231



MOLD BASE SUPPORT

OEM: 01071437908

UMS-714379



BEARING RING



OEM: 01071552702
UMS-715527

THRUST

OEM: 01072804901
UMS-728049



GUIDE RING

OEM: 01073332601
UMS-733326



LOCKING THRUST

OEM: 01074290601
UMS-742906



WATER JACKETS

LEFT SIDE MOLD SHELL
UMS-01117166401



RIGHT SIDE MOLD SHELL
UMS-01117166301



WE DO HAVE OTHER # REFERENCE AVAILBLE. ASK OUR TEAM FOR A QUOTATION

UM CAN REVERSE ENGINEER ALL MOLD SHELL DESIGN (ALUMINUM AND STAINLESS STEEL), SIMPLY PROVIDE A SAMPLE.

STRETCH ROD CLAMP ASS'Y

IMPROVED STRETCH ROD CLAMP ASS'Y (HEAT SET)
0002-005-02-32



IMPROVED STRETCH ROD CLAMP ASS'Y (COLD SET)
0002-005-02-38



RETAINER PLATE BOTTOM (IMPROVED PART - 60 RC
COMPARED TO 15 RC FROM OEM)
UMS-727970



RETAINER PLATE TOP (IMPROVED PART - 60 RC
COMPARED TO 15 RC FROM OEM)
UMS-723367



STRETCH ROD CLAMP (HEAT SET) (IMPROVED PART - 60
RC COMPARED TO 15 RC FROM OEM)
UMS-729281



STRETCH ROD CLAMP (COLD SET) (IMPROVED PART - 60
RC COMPARED TO 15 RC FROM OEM)
UMS-694716



STRETCH ROD CYLINDER



UMS-STRETCHROD-S2

BENEFITS

- Drop-in replacement
- Insensitivity to contamination and pressure variations
- Repeatable response time
- High flow capacity of the valve to ensure fast retract or the stretching cam
- Cost Savings: Increased production, reduced labor cost and few replacement parts
- ISO compatible with MAC pilot valves

STRETCH ROD CYLINDER SPARE KITS
UMS-STRETCHROD-S2-KIT

BLOW NOZZLE COMPONENTS (INCLUDING PDP PARTS)

S2 DIFFUSOR 14MM
UMS-727460



TUBE SPACER LONG
UMS-742006



TUBE SPACER
UMS-746089 & 727458



S2 CYLINDER NECK ASSY
UMS-134656M



CYLINDER NECK
OEM: 010747728
UMS-747728M



RING
OEM: 010746710
UMS-746710M



END PIECE
OEM: 010746128
UMS-746128M



CYLINDER NECK HEIGHT ASSY

Available in different shapes and sizes
Contact UM for our part number



CYLINDER

OEM: 010727467
UMS-727467



END PIECE

OEM: 010727457
UMS-727457



CYLINDER NECK HEIGHT

OEM: 010745985
UMS-745985M



CYLINDER NECK HEIGHT

OEM: 010742007
UMS-742007M



END PIECE

OEM: 010744524
UMS-744524M



END PIECE

OEM: 010744553
UMS-744553M



END PIECE

OEM: 010268379
UMS-268379



NOZZLE CAP

OEM: 010725134

UMS-725134



BELL IMPROVEMENT 75MM

OEM: 011210601/010727456

UMS-210601

ASK US ABOUT OUR REBUILD PROGRAM



BELL IMPROVEMENT 80MM

OEM: 010746615

UMS-746615

ASK US ABOUT OUR REBUILD PROGRAM



NUT WITH NOTCHES

OEM: 13031

UMS-13031



BLOW NOZZLE CAP

OEM: 77170

UMS-77170



IMPROVED BELL NOZZLE 43MM

OEM: 0111437360

UMS-143736



NOZZLE SEAL (ANY DIMENSION AVAILABLE ON REQUEST)

OEM: 01074313801

UMS-743138



NOZZLE WITH NECK EDGE SUPPORT

OEM: 010746615

UMS-746615



NOZZLE-W/NECK EDGE

OEM: 01073318101

UMS-733181



S2 + CYLINDER NECK ASSY

0002-005-01-23



S2 + CYLINDER NECK

OEM: 746095

UMS-746095



RING

OEM: 010746710

UMS-746710M



END PIECE

OEM: 010746128

UMS-746128M



ROTARY UNION

AIR ROTARY UNION REBUILD

OEM P/N: 99000411427

UMS- 99000411427

WATER ROTARY UNION REBUILD

OEM P/N: 1002131803

UMS-1002131803



UM TAKES CARE OF SHIPPING YOU A STOCK REBUILT UNIT AND UPON RECEPTION AND INTALLATION AT YOUR PLANT, YOU SHIP US YOUR DAMAGED ROTARY UNION. WHEN WE RECEIVE IT, WE WILL EVALUATE IT, INSPECT IT AND REBUILD IT.

HERE ARE THE THINGS WE DO:

- NEW INNER BEARINGS, SEALS AND WEAR BANDS ARE INSTALLED
- AN INSPECTION IS DONE ON ALL BEARING SEATS AND WEAR BAND SURFACES TO EVALUATE IF A COMPLETE REPAIR IS NEEDED.
- ALL SURFACES ARE POLISHED AND ALL THREADS AND PORTS ARE INSPECTED TO AVOID LEAKING ISSUES.
- EACH UNIT IS TESTED FOR LEAKAGE PRIOR TO SHIPMENT.

S2 BLOW/PREBLOW & EXHAUST VALVES AND ACCESSORIES

NEW S2 BLOW/PREBLOW **ECO** VALVE ASS'Y
UMS-114583-ECO (SEE DETAILS ON PAGE 33)



NEW S2 EXHAUST **ECO** VALVE ASS'Y
UMS-114585-ECO (SEE DETAILS ON PAGE 33)



NEW S2 BLOW-PREBLOW VALVE ASS'Y WITH MAC
PILOT VALVE/PLATE (TYPE 2629)
UMS-114583N



NEW S2 EXHAUST VALVE ASS'Y WITH MAC
PILOT VALVE/PLATE (TYPE 2629)
UMS-114585N



PISTON KIT FOR BLOW VALVE WITH IMPROVED SOLUTION
(type 2628 & 2629)
0002-001-01-09



MAC PILOT VALVE AND ADAPTER PLATE
(BLUE: BLOW/PREBLOW)
0002-001-01-47



MAC PILOT VALVE AND ADAPTER PLATE
(RED: EXHAUST)
0002-001-01-48



SEALS REBUILD KIT FOR UMS-114583N & UMS-114585N

OEM: 99000413939

0002-001-01-29



SPARE PARTS KIT FOR S2 COMPENSATION VALVE (01123429701)

0002-001-02-34



IMPROVED COMPENSATION VALVE WITH MAC PILOT VALVE S2, S2+ & Universal

UMS-234297-N7BAR

(SEE DETAILS ON PAGE 34)



S2+ BLOW/PREBLOW, RECOVERY & EXHAUST VALVES AND ACCESSORIES

NEW BLOW VALVE ASS'Y

OEM: 01122464602

UMS-224646N



NEW PREBLOW VALVE ASS'Y

OEM: 01122464702

UMS-224647N



NEW RECOVERY VALVE ASS'Y

UMS-226565N



NEW EXHAUST VALVE ASS'Y

OEM: 01122464802

UMS-224648N



MAC PILOT VALVE AND ADAPTER PLATE

(BLUE: AIR RECOVERY)

0002-001-04-11



MAC PILOT VALVE AND ADAPTER PLATE

(RED: EXHAUST)

0002-001-04-10



MAC PILOT VALVE AND ADAPTER PLATE
(BLUE: BLOW/PRE-BLOW)
0002-001-04-09



PISTON KIT FOR VALVE WITH IMPROVE SOLUTION
0002-001-03-09



S2+ VALVES SEAL KIT
0002-001-04-12



S2 ECO-VALVES



BENEFITS

- Includes all new components
- Improved internals to reduce maintenance cost and time for rebuild
- Ass'y composed of much less components
- Plug & play unit
- No core return
- Dead space volume reduced by 30% per station (compared to OEM valves)
- 1 year warranty



OEM S2 Valve

OEM S2 VALVE
CONVERTED BY um (STILL
AVAILABLE)

UM's S2-ECO Valve

IMPROVED COMPENSATION VALVE FOR S2/S2+ & UNIVERSAL



Improved Compensation valve
UMS-234297-N7BAR

BENEFITS

- Standard MAC pilot valve
- 1 Year Warranty
- Higher longevity compared to OEM
- No core return
- More reliable compared to OEM

LOCK & UNLOCK CAM



SBO 16,18 & 20 Bottom Up Cam
UMS-01072735202

SBO 16,18 & 20 Bottom Down Cam
UMS-01071866103

SBO 16,18 & 20 Locking Cam
UMS-01112912905

SBO 16,18 & 20 Unlocking Cam
UMS-01111240503

SBO 16,18 & 20 Intermediary Shaft
UMS-01071334201

E : EXIT WHEEL



PREFORM CHANGE/TOOL CHANGE

UM'S ENGINEERING TEAM CAN HELP YOU DESIGN ALL THE CUSTOM PARTS REQUIRED TO CHANGE FROM ONE PREFORM TO ANOTHER.

WITH ITS EQUIPMENT AND KNOW HOW, UM'S ENGINEERING TEAM WILL KEEP ALL THE REQUIRED OEM SPECIFICATIONS.

UM GENERAL INFORMATION

About us

Founded in 1976, UM Inc has been an industry pioneer by focusing on the synergy between the skills of our engineering team and the versatility of our manufacturing department at the leading edge of technologies. This structure allows us to offer very high quality products and an enormous variety of services in any specialized areas.

Our mission

We are committed to develop and maintain a growing association with our clients, by creating new and innovative products that improve the quality of their own machinery.

Our plant



For more information, please visit our official website at www.um-inc.com